

PART NUMBER	ITEM 1 HANDLE (QTY)	ITEM 2 ACTUATOR (QTY)	ITEM 3 BUTTON (QTY)	ITEM 4 PLATE (QTY)	ITEM 5 LKCYL (QTY)	ITEM 6 O-RING (QTY)	ITEM 7 SPRING (QTY)	ITEM 8 PIN (QTY)	ITEM 9 SCREW (QTY)	KEYS SUPPLIED YES/NO (QTY)	PART MARKING
12447	81775 (1)	12346-09 (1)	12347-35 (1)	12345-16 (1)	81168-02 (1)	80773 (1)	80768-57 (1)	14392-01 (1)	81789-15 (2)	YES (2)	12447
12447-01	(1)	(1)	(1)	(1)	81168-10 (1)	(1)	(1)	(1)	(2)	NO	

REVISION	ECN	ECN BY	DESCRIPTION
6	19687	TEB 6/30/03	MOVED BOM; ADDED -01 VERSION; REMOVED NOTE 5 & RENUMBERED; UPDATED PROD CODE; ADDED PRT WEIGHT
7	19925	GDE 03/31/04	ADDED: ROTATION INDICATOR, NOTES 6 & 7, PR VIEWS/DIMS, KEYS SUPPLIED COLUMN TO BOM REVISED BOM FORMAT.
8	37756	RLO 3-28-12	UPDATED DRAWING FORMAT. ADDED PART MARKING COLUMN. REVISED PART MARK LOCATION. 12447 WAS 12447-00, 81775 WAS 81775-00, 80773 WAS 80773-00.

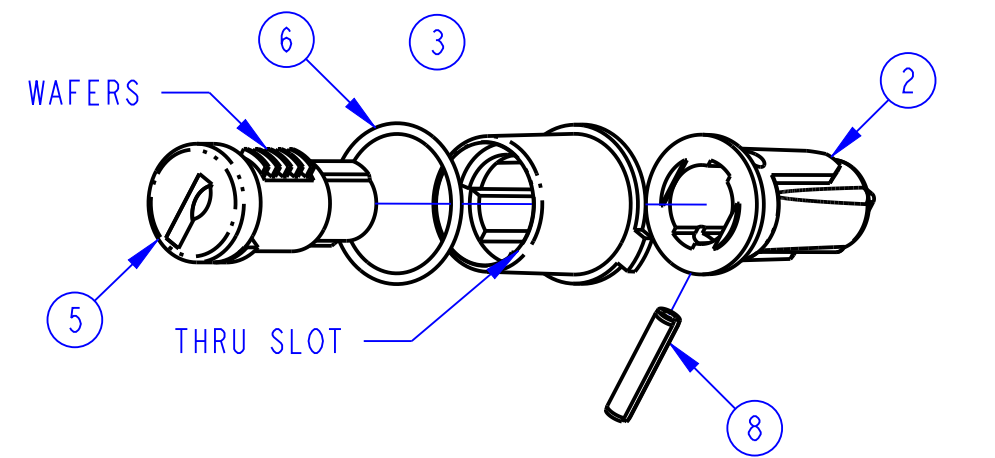

LOCKCYLINDER / PUSHBUTTON / ACTUATOR ORIENTATION

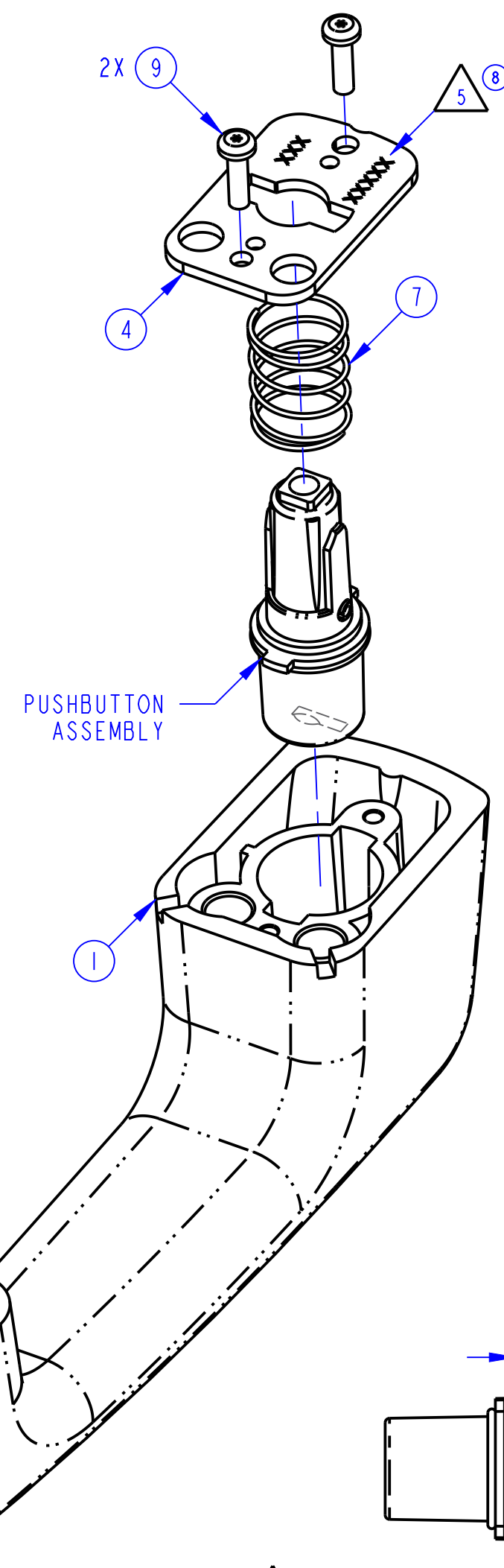
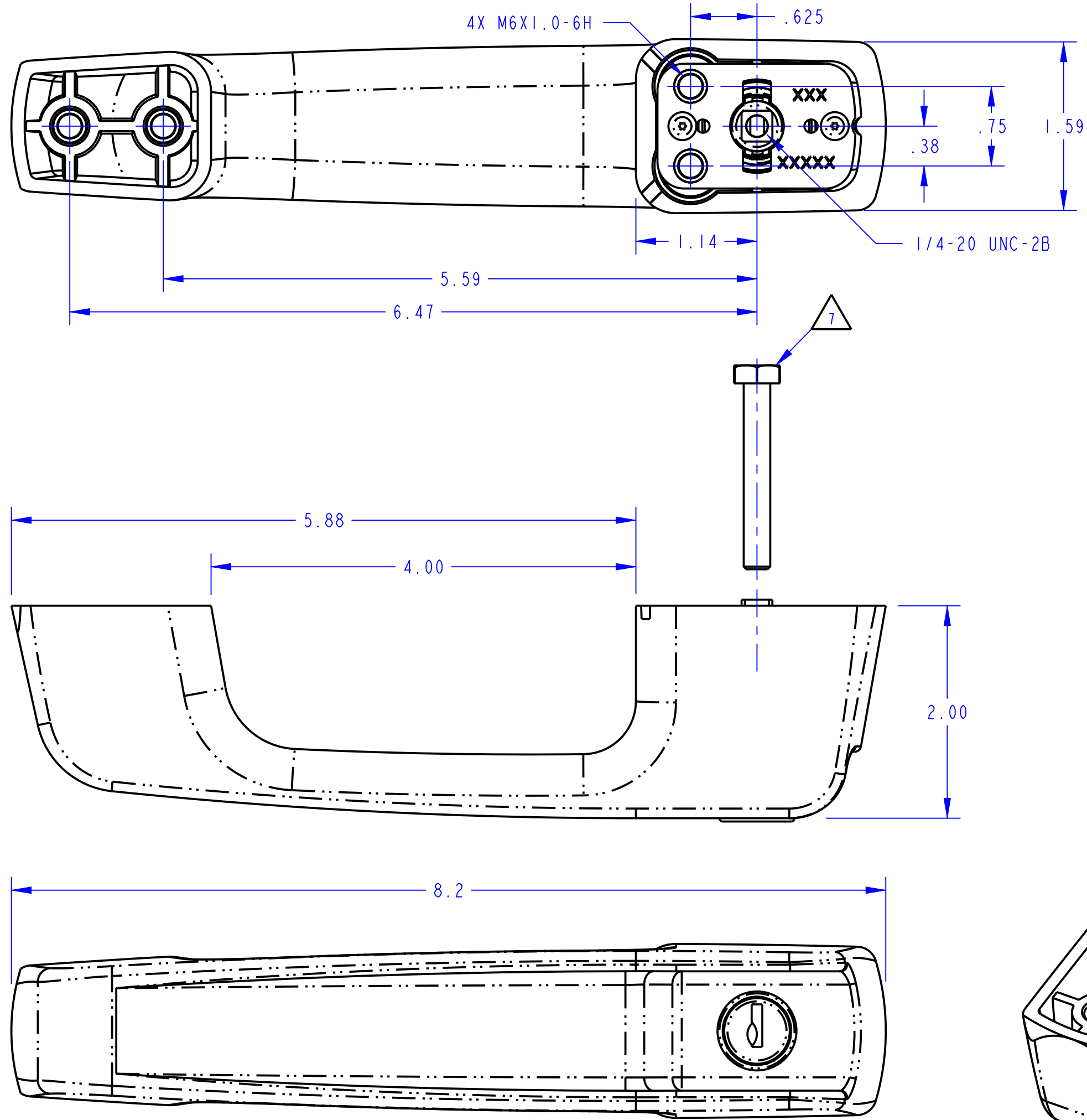
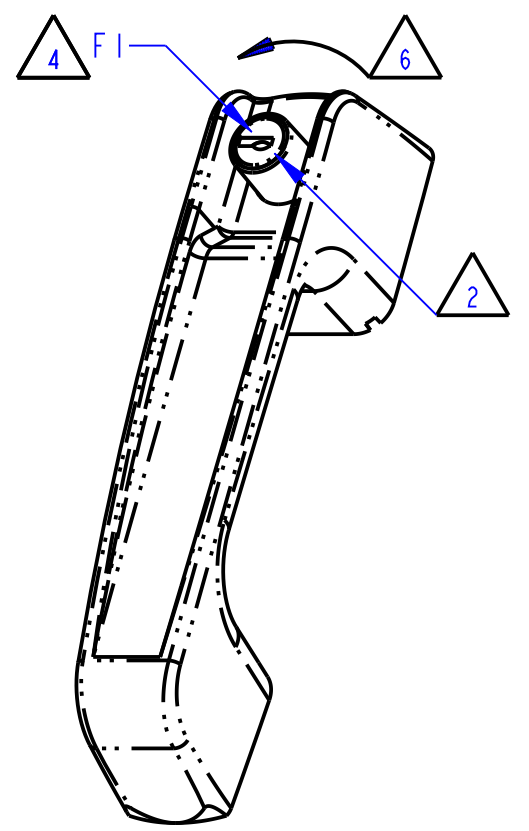

ISO VIEW SCALE 0.50

EXPLODED VIEW

PUSHBUTTON SUBASSEMBLY DETAIL

- NOTES: UNLESS OTHERWISE SPECIFIED; ⑥
- ① LOCKCYLINDER (ITEM 5) TO BE ASSEMBLED INTO PUSHBUTTON (ITEM 3) AND THEN DRILLED AND PINNED TO ACTUATOR (ITEM 2) AS SHOWN.
 - ② PUSHBUTTON ASSEMBLY TO BE SHIPPED IN UNLOCKED POSITION.
 - ③ PUSHBUTTON TO HAVE SHUTTERED LOCKCYLINDER WITH "O"-RING.
 - ④ THE INITIAL FORCE, FI, REQUIRED TO DEFLECT THE PUSHBUTTON SHALL BE 2.25 LB ±.50 LB.
 - ⑤ STAMP LOCK PLATE (ITEM 4) WITH PART NUMBER AND DATE CODE WITH .094 HIGH CHARACTERS PER ES-121. LOCATE APPROXIMATELY AS SHOWN.
 - ⑥ ROTATE LOCKCYLINDER (ITEM 5) 90° COUNTERCLOCKWISE TO LOCK.
 - ⑦ PUSHBUTTON SHOULD BE UNLOCKED AND FULLY DEPRESSED WHEN INSTALLING SCREW (SCREW TO BE SUPPLIED BY OTHERS) INTO ACTUATOR AT 78±6 IN-LB.

<p>⑧ INDICATES REQUIRED ASSEMBLY INFORMATION. UOS: THE -00 VERSION SHALL BE THE UNFINISHED VERSION OF PART SHOWN. UOS: ALL DIMENSIONS APPLY BEFORE COATING. (ASME Y14.5M, sec. 2.4.1)</p>		<p>TriMark 500 Bailey Avenue P. O. Box 350 New Hampton, Iowa 50659 U.S.A. Tel: 641-394-3188 Fax: 641-394-2392</p>																																							
<p>TOLERANCES UNLESS OTHERWISE SPECIFIED (UOS) ASME Y14.5M-1994</p> <table border="0"> <tr> <td>INCH</td> <td>MILLIMETER</td> </tr> <tr> <td>X.X = ±.1</td> <td>X = ±.3</td> </tr> <tr> <td>X.XX = ±.03</td> <td>X.X = ±.8</td> </tr> <tr> <td>X.XXX = ±.010</td> <td>X.XX = ±.25</td> </tr> </table> <p>ANGLES X° = ±3° X.X° = ±1.0° X.XX° = ±.50°</p>		INCH	MILLIMETER	X.X = ±.1	X = ±.3	X.XX = ±.03	X.X = ±.8	X.XXX = ±.010	X.XX = ±.25	<table border="0"> <tr> <td>DRAWN BY</td> <td>KPE</td> <td>10/7/92</td> </tr> <tr> <td>CHECKED BY</td> <td>TMG</td> <td>11/5/92</td> </tr> <tr> <td>PROJECT</td> <td>92024</td> <td>PRODUCT CODE</td> </tr> <tr> <td></td> <td></td> <td>D03 (040-0300)</td> </tr> <tr> <td>CUSTOMER</td> <td colspan="2"></td> </tr> <tr> <td>CUSTOMER PART NUMBER</td> <td colspan="2"></td> </tr> <tr> <td>PART WEIGHT</td> <td>(0.50 LB)</td> <td>⑥ SURFACE AREA</td> </tr> <tr> <td>SIZE</td> <td>C</td> <td>SCALE</td> </tr> <tr> <td></td> <td></td> <td>1.0</td> </tr> <tr> <td>PART NUMBER</td> <td colspan="2">12447</td> </tr> </table>		DRAWN BY	KPE	10/7/92	CHECKED BY	TMG	11/5/92	PROJECT	92024	PRODUCT CODE			D03 (040-0300)	CUSTOMER			CUSTOMER PART NUMBER			PART WEIGHT	(0.50 LB)	⑥ SURFACE AREA	SIZE	C	SCALE			1.0	PART NUMBER	12447	
INCH	MILLIMETER																																								
X.X = ±.1	X = ±.3																																								
X.XX = ±.03	X.X = ±.8																																								
X.XXX = ±.010	X.XX = ±.25																																								
DRAWN BY	KPE	10/7/92																																							
CHECKED BY	TMG	11/5/92																																							
PROJECT	92024	PRODUCT CODE																																							
		D03 (040-0300)																																							
CUSTOMER																																									
CUSTOMER PART NUMBER																																									
PART WEIGHT	(0.50 LB)	⑥ SURFACE AREA																																							
SIZE	C	SCALE																																							
		1.0																																							
PART NUMBER	12447																																								
<p>DO NOT SCALE DRAWING</p> <p>REF. T/M OP 4.20-2 FOR SUP. QUALITY REQ. REF. T/M OP 4.20-3 FOR INT. QUALITY REQ.</p>		<p>This drawing and the information contained herein is the property of TriMark Corporation and shall not be used for any purpose without our written consent.</p>																																							